



PLN2501
LED LCD Monitor

USER'S GUIDE

www.planar.com

This document may not be copied in any form without permission from Planar. Information in this document is subject to change without notice.

Trademark Credits

Windows™ is a trademark of Microsoft Corp



The terms HDMI, HDMI High-Definition Multimedia Interface, HDMI trade dress and the HDMI Logos are trademarks or registered trademarks of HDMI Licensing Administrator, Inc.

All other companies are trademarks or registered trademarks of their respective companies.

Disclaimer

The information contained in this document is subject to change without notice. Planar Systems, Inc. makes no warranty of any kind with regard to this material. While every precaution has been taken in the preparation of this manual, the Company shall not be liable for errors or omissions contained herein or for incidental or consequential damages in connection with the furnishing, performance, or use of this material.



ENERGY STAR is a program run by the U.S. Environmental Protection Agency (EPA) and U.S. Department of Energy (DOE) that promotes energy efficiency. This product qualifies for ENERGY STAR in the “factory default” settings and this is the setting in which power savings will be achieved. Changing the factory default picture settings or enabling other features will increase power consumption that could exceed the limits necessary to qualify for ENERGY STAR rating. For more information on the ENERGY STAR program, refer to energystar.gov.

Content

| | |
|----------------------------------|----|
| Operation Instructions | 1 |
| Unpacking Instructions | 3 |
| Safety Precautions..... | 3 |
| Consignes de sécurité..... | 4 |
| Package Overview..... | 5 |
| First Setup..... | 6 |
| Front View of the Product..... | 7 |
| Rear View of the Product..... | 8 |
| Quick Installation..... | 9 |
| Basic Operation..... | 10 |
| OSD Lock Out Function..... | 11 |
| Advanced Operation—OSD Menu..... | 12 |
| Supporting Timing Modes..... | 14 |
| Technical Information..... | 15 |
| Wall-mount instruction..... | 16 |
| Care and Maintenance..... | 17 |
| Troubleshooting..... | 17 |
| Planar Support..... | 18 |

Operation Instructions

Thank you for purchasing the PLN2501 LED LCD monitor. Please read this guide thoroughly before installation.

FCC RADIO FREQUENCY INTERFERENCE STATEMENT WARNING: (FOR FCC CERTIFIED MODELS)

This LED LCD Monitor has been tested and found compliant with the limits for a Class B digital device, pursuant to Part 15 of the FCC Rules. These limits are designed to provide proper protection against harmful interference to a residential installation. This LED LCD Monitor generates, uses, and can radiate radio frequency energy. Harmful interference to radio communication may be led as a result if it's not properly installed and used. However, there is no guarantee that interference will not occur in a particular installation. If this LED LCD Monitor does cause serious interference to radio or television reception, resetting the LED LCD Monitor may determine it. Moreover, users are encouraged to correct interference by doing one or more of the following:

- Reorient or relocate the receiving antenna.
- Move the LED LCD Monitor and the receiver further away from each other.
- Connect the LED LCD Monitor into an outlet on a circuit different from that to which the receiver is connected.
- Consult your local dealer or an qualified technician.

FCC Warning:

To assure a continued FCC compliance, a user must use a grounded power supply cord and the provided shielded video interface cable with bonded ferrite cores. Also, any unauthorized changes or modifications to this LED LCD Monitor would void the user's authority to operate this device.

Note: If necessary, shielded interface cables and AC power cord must be used to meet the emission level limits.



Important Waste Disposal Information

Please recycle or dispose of all electronic waste in accordance with local, state, and federal laws. Additional resources can be found online at <http://www.planar.com/about/green/>.

The crossed-out wheeled bin symbol is to notify consumers in areas subject to Waste Electrical and Electronic Equipment (WEEE) Directive 2012/19/EU that the product was placed on the market after August 13, 2005 and must not be disposed of with other waste. Separate collection and recycling of electronic waste at the time of disposal ensures that it is recycled in a manner that minimizes impacts to human health and the environment. For more information about the proper disposal of electronic waste, please contact your local authority, your household waste disposal service, or the seller from whom you purchased the product.

COMMUNIQUE D'AVERTISSEMENT DE LA FCC CONCERNANT LES INTERFERENCE DE FREQUENCE RADIO: (SEULEMENT POUR MODELES CERTIFIE PAR LA FCC)

Ce moniteur a été testé et à été trouvé conforme aux limites pour un appareil numérique de Classe B, suivant la partie 15 des règlements de la FCC. Ces limites ont été développées pour offrir une protection satisfaisante contre les interférences nuisibles dans une installation résidentielle. Ce moniteur génère, utilise et peut radier de l'énergie de fréquence radio. Ceci peut causer des interférences nuisibles à des communication radio si l'appareil n'est pas convenablement installé et utilisé. Il n'y a néanmoins aucune garantie que des interférences n'apparaîtront pas dans une installation particulière. Si ce moniteur cause de sérieuses interférences à la réception de signaux radios ou télévisées, une possibilité est de réinitialiser le moniteur. Les usagers sont aussi encouragés à corriger les interférences en appliquant une ou plusieurs des démarches suivantes:

- Réorientez ou déplacez l'antenne de réception.
- Placez le moniteur et le récepteur plus loin l'un de l'autre.
- Connectez le moniteur à une prise différente de celle à laquelle le récepteur est connecté.
- Consultez votre revendeur local ou un technicien qualifié.

Avertissement de la FCC:

Pour assurez une conformité continue au règlements de la FCC, l'utilisateur doit utiliser un cordon d'alimentation mis à terre et le câble d'interface vidéo protégé avec noyaux en ferrite, fourni avec l'appareil. Chaque modification ou changement non-autorisé appliqué à ce moniteur peut faire perdre à l'utilisateur sont droit d'opération de cet appareil.

Note: Si nécessaire, des câbles d'interface protégés et un cordon d'alimentation alternante doivent être utilisé pour être conforme aux limites d'émission.

Unpacking Instructions

- Move the LED LCD Monitor out of the package and take off the plastic bag and Polystyrene Foam.
- Remove stand and base from plastic bags and attach to the monitor.

Safety Precautions

Follow all warnings, precautions and maintenance as recommended in this user's manual to maximize the life of your unit.

Do:

- Turn off the product before cleaning.
- Surface may be cleaned using a soft clean cloth moistened with mild window glass commercial cleaners or 50/50 mixture of water and isopropyl alcohol.
- Use a soft cloth moistened with mild detergent to clean the display housing.
- Disconnect the power plug from AC outlet if the product is not going to be used for an extended period of time.

Don't:

- Do not touch the LED display screen surface with sharp or hard objects.
- Do not use abrasive cleaners, waxes or solvents for your cleaning.
- Do not operate the product under the following conditions:
 - Over 16 hours per day.
 - Extremely hot, cold or humid environment.
 - Areas susceptible to excessive dust and dirt.
 - Near any appliance generating a strong magnetic field.
 - In direct sunlight.
- If smoke, abnormal noise or odor emits from your LED LCD Monitor, remove the power cord immediately and call your service center.
- Never remove the rear cover of your LED LCD Monitor. The display unit inside contains high-voltage parts and may cause electric shock.
- Never try to repair your LED LCD Monitor yourself. Always call your service center or a qualified technician to fix it.
- Due to safety concerns, if the VESA mounting kit is purchased separately, please make sure the mounting kit is UL-listed, and replaceable only by service personnel.

Consignes de sécurité

Respectez tous les avertissements, les précautions et conseils d'entretien recommandés dans ce manuel de l'utilisateur pour maximiser la durée de vie de votre appareil.

A faire :

- Éteindre le produit avant de le nettoyer.
- La surface de l'écran tactile peut être nettoyée avec un chiffon doux et propre imprégné d'un nettoyant doux du commerce pour vitres ou d'un mélange à 50/50 d'alcool isopropylique et d'eau.
- Utilisez un chiffon doux imprégné d'un détergeant doux pour nettoyer le carter de l'affichage.
- Débranchez la fiche d'alimentation de la prise de courant secteur si le produit ne doit pas être utilisé pendant une période prolongée.

A ne pas faire :

- Ne touchez pas la surface de l'écran LED avec des objets coupants ou durs.
- N'utilisez pas des produits de nettoyage abrasifs, de la cire ou des solvants pour le nettoyage.
- N'utilisez pas le produit dans les conditions suivantes :
 - Plus de 16 heures par jour.
 - Environnement extrêmement chaud, froid ou humide.
 - Endroits poussiéreux ou sales.
 - Près d'appareils générant un fort champ magnétique.
 - Sous la lumière directe du soleil.
- Si de la fumée, un bruit anormal ou une odeur s'échappait de votre moniteur LCD LED, débranchez immédiatement le cordon d'alimentation et appelez votre centre de réparation.
- Ne retirez jamais le couvercle arrière de votre moniteur LCD LED. L'unité d'affichage contient des éléments où circule un voltage élevé et présentant un risque d'électrocution.
- N'essayez jamais de réparer vous-même votre moniteur LCD LED. Faites toujours appel à votre centre de service ou à un technicien qualifié pour toute réparation.
- Pour des raisons de sécurité, si vous achetez séparément le kit de fixation VESA, assurez-vous que celui-ci est certifié UL, et qu'il peut être remplacé uniquement par un technicien qualifié.

Package Overview

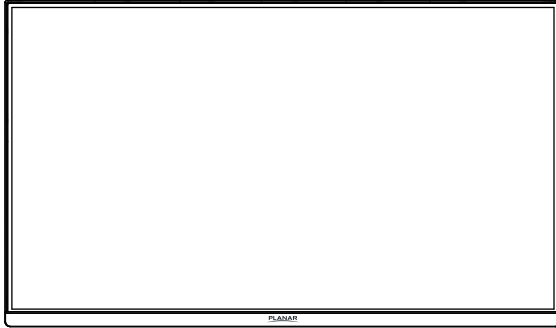

LED LCD Monitor

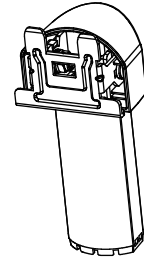

Stand

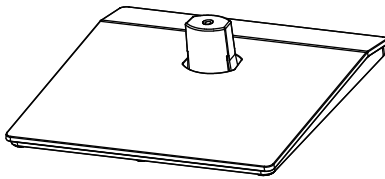

Base

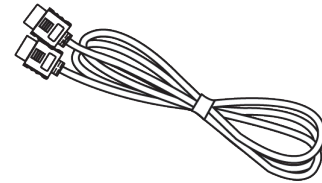

HDMI Cable

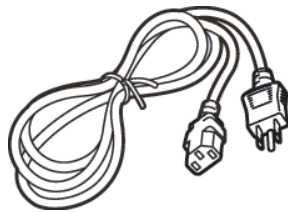

Power Cord

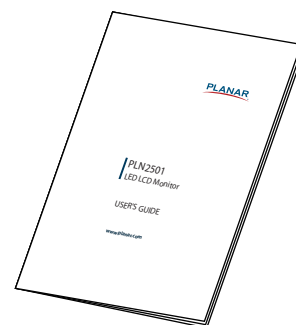

User's Guide

First Setup

Installing the Stand Base

1. Lay the LED LCD Monitor flat on a table with the LED screen face down. To prevent the LED LCD Monitor from being scratched, put a piece of soft cloth on the table on which the screen will be set.
2. Insert Stand and Base into the monitor as shown below.
3. Stand the LED LCD Monitor up.

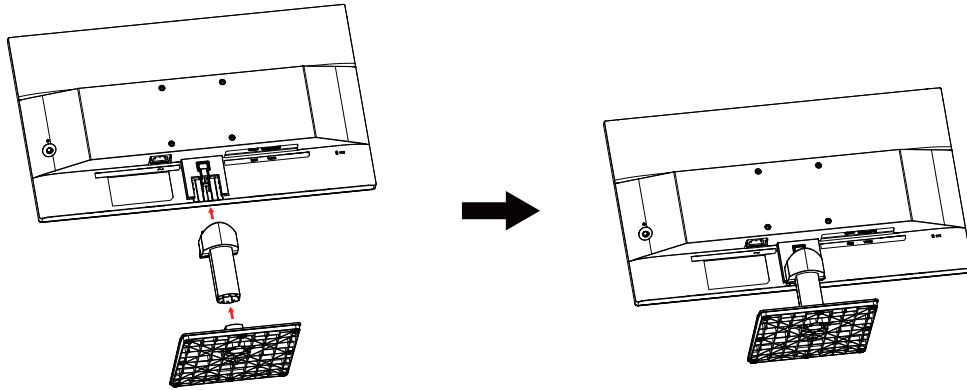

Disconnecting the Stand Base

1. Lay the LED LCD Monitor flat on a table with the screen face down. To prevent the LED LCD Monitor from being scratched, put a piece of soft cloth on the table on which the screen will be set.
2. Push release button and pull stand away from monitor.

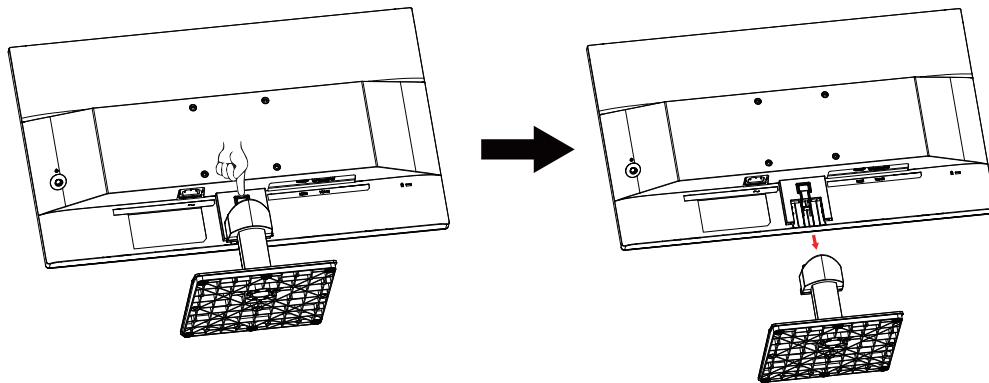

3. Press the tenons inwardly and pull the base from stand to remove.

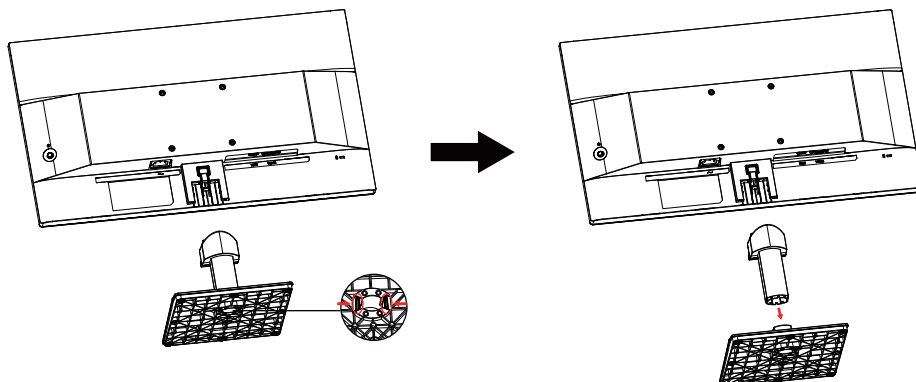

Front View of the Product

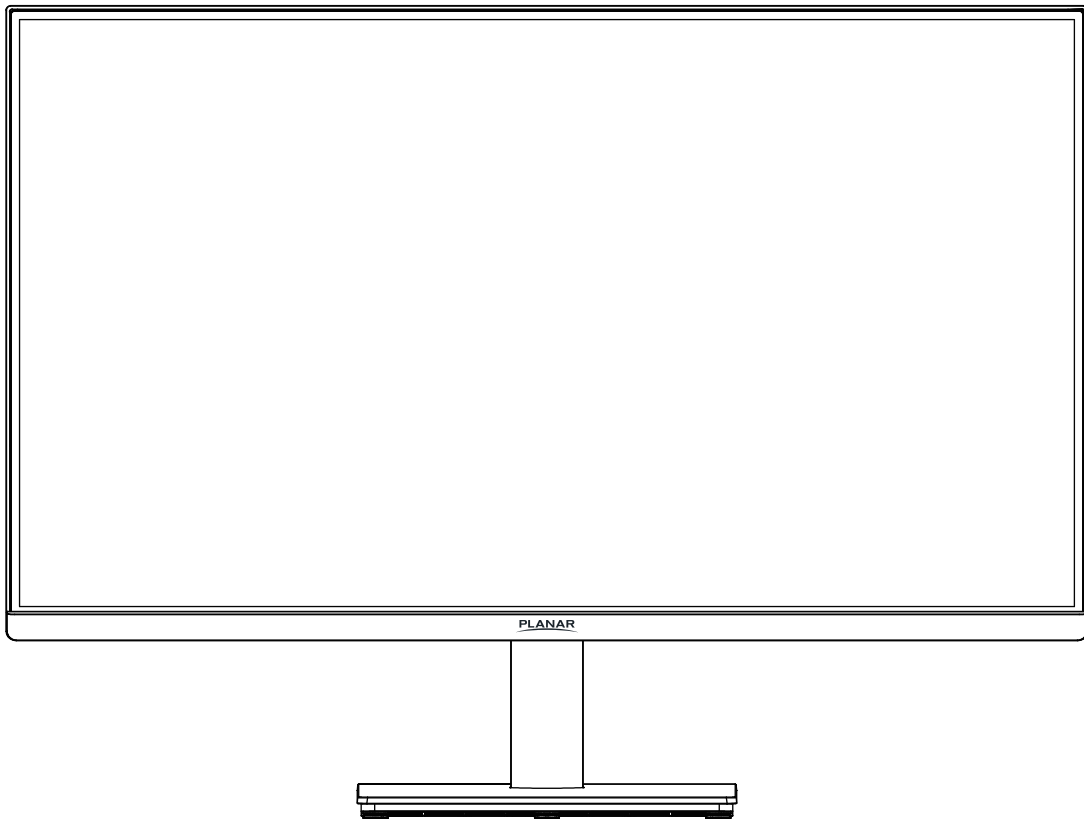

Rear View of the Product

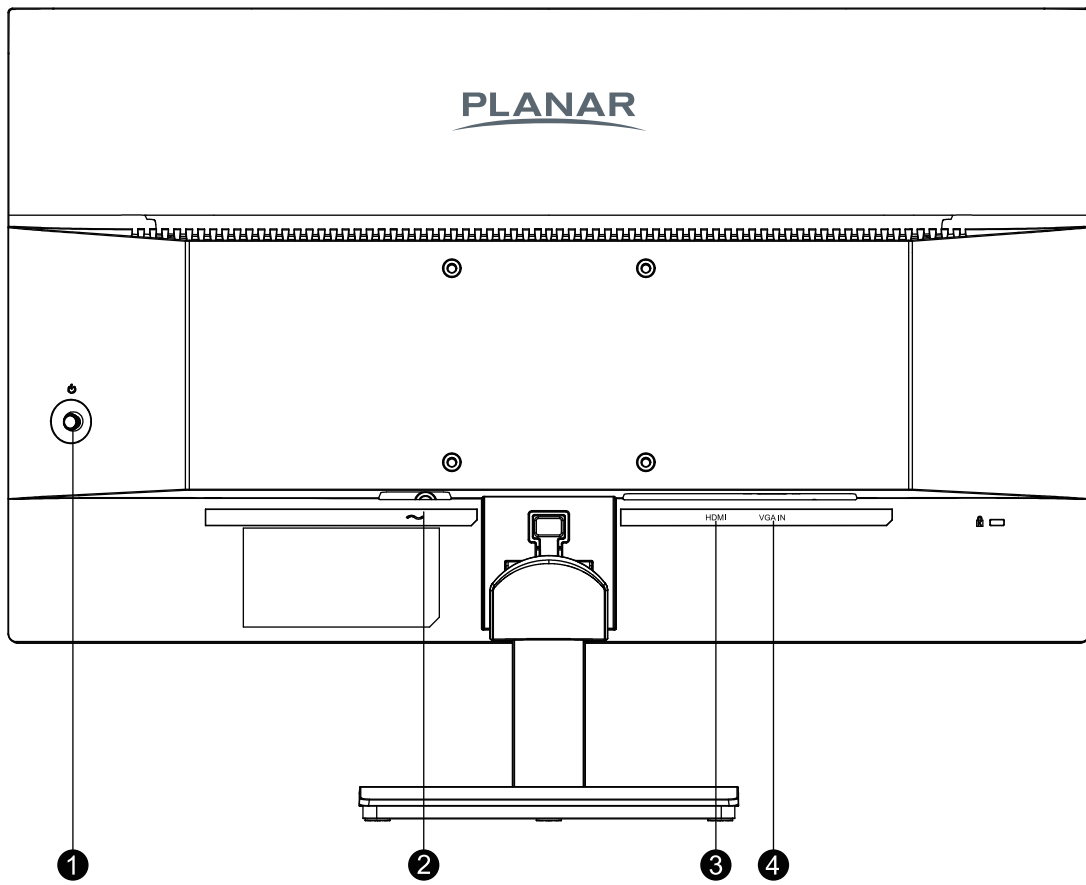

| | |
|---|---|
| ① | LED Indicator |
| ① | Joystick (Power/Menu/Navigation/Enter/Exit/Hotkey button) |
| ② | Power input (AC input) |
| ③ | HDMI input (HDMI 19 pin) |
| ④ | VGA Input (D-Sub 15 pin) |

Quick Installation

1. Connect either VGA or HDMI Video Source from the monitor to the computer. Make sure both monitor and computer are powered OFF.
2. Connect the power cord to a properly grounded AC outlet, then to the monitor.
3. Power-ON computer and then POWER-ON the monitor. Set the timing mode on your computer. Recommended resolution and refresh rate is 1920 x 1080 @ 100Hz for HDMI/ @ 60Hz for VGA.

Figure 1:

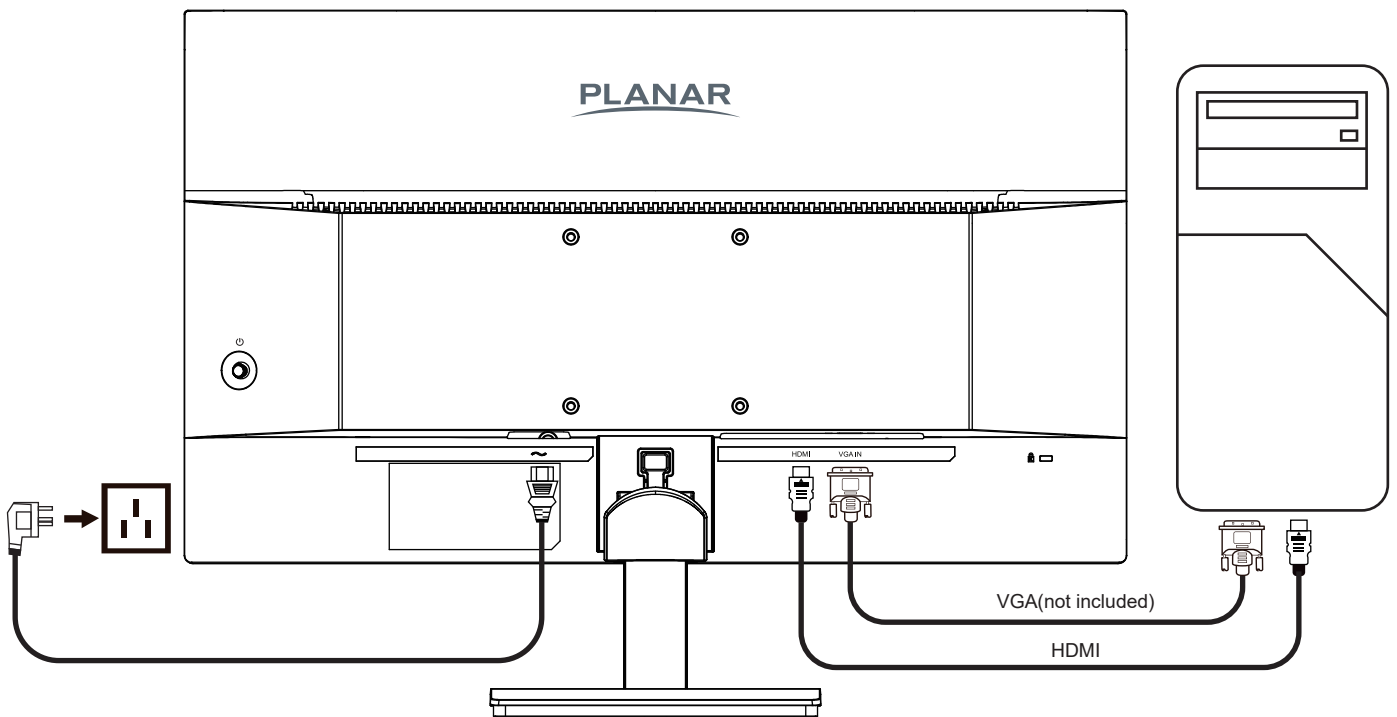



Basic Operation

Before using the LED LCD monitor:

- Connect external equipments properly.
- Insert the power plug, and the power LED indicator will be lit.

Power On/Off

To turn on the monitor, press the center button  of the joystick button on the back of the LED LCD monitor. The power LED indicator lights blue when the LED LCD monitor is on.



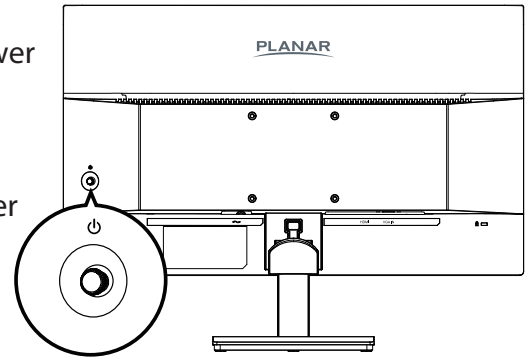

To turn off the monitor, press the center button  of the joystick button for 3 seconds until the LED light on the power button turns off.

Solid orange indicates the monitor is in standby mode.



Using the OSD Menu

You are able to use OSD menus to adjust various settings by using menu button on the front of the LED LCD monitor.

| | |
|---|--|
|  | When not in the OSD menu, enter the preset mode selection. |
| | Select the desired item when in OSD menu |
|  | When not in the OSD menu, adjust the display brightness. |
| | Select the desired item when in OSD menu |
|  | When not in the OSD menu, display the main menu. |
| | Exit/Return to the previous menu level in the OSD menu. |
| | Hold 3 sec enters OSD lock, and hold 3 sec again for unlock. |
|  | When not in the OSD menu, enter the input selection menu. |
| | Select the desired item when in OSD menu |
| | Hold 3 sec enters Power lock, and hold 3 sec again for unlock. |
|  | When not in the OSD menu, short press displays the main menu. |
| | Short press for enter/OK when in the OSD menu. |
| | Short Press to turn on. Long Press for 3 sec to turn off. |

OSD Lock Out Function

When LED LCD Monitor is in normal mode, the "OSD Lock Out" function can be enabled.

Option 1: OSD lock – All buttons are locked except the "POWER" key.

Press and hold the  button for 3 seconds to lock the OSD button.

The LED LCD Monitor will show an "OSD Locked" message for 3 seconds and the message will disappear automatically.

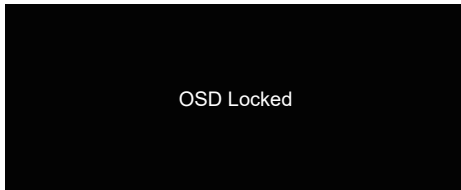

Repeat this step to unlock.

Option 2: OSD & Power button lock - All 5 buttons including the "POWER" button are locked.

Press and hold the  button for 3 seconds to lock all buttons.

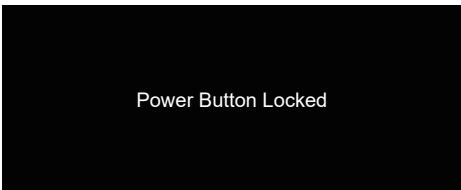

The LED Monitor will show a "Power Button Locked" message for 3 seconds and the message will disappear automatically.



Repeat this step to unlock.

Advanced Operation—OSD Menu



You can use the OSD menu to adjust various settings for your LED LCD monitor.

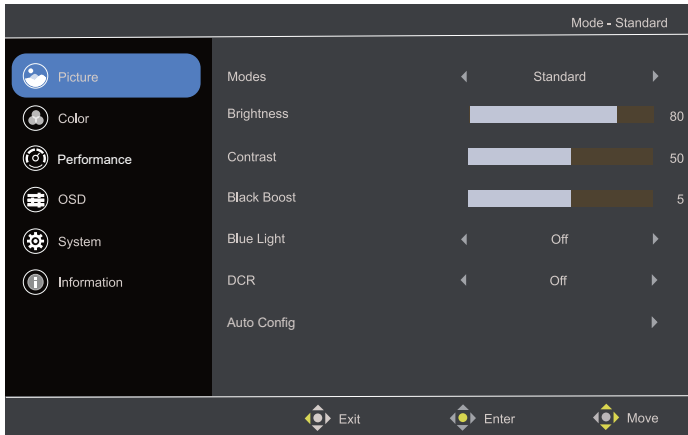

Press the  button to display the OSD Menu, and use  to select the desired OSD menu.





 **Picture:** Picture adjustment: manually adjust the modes, brightness, contrast, black boost, blue light, and DCR (Dynamic Contrast Ratio) of the screen image.

Modes: Optimize picture quality for general content. Use  to scroll through the Picture preset settings: Standard, ECO, Graphics, Movie, Action, Racing, Sports, User.

Brightness: To adjust the luminance of the video.
: increase brightness, : decrease brightness

Contrast: To adjust the foreground white level of screen image.
: increase contrast, : decrease contrast.

Black Boost: This boosts the amplitude of the dark color levels of the display-blacks will be less black.
: increase Black Boost, : decrease Black Boost.

Blue Light: Adjust the proportion of blue light display to filter out blue light. Use the  button to scroll through the settings: Off, -15%, -30%, -50%, -70%.

DCR: Dynamic Contrast Ratio. Turn DCR on or off. The default is off.

Auto Config (Only available in VGA mode): To adjust the picture automatically.
H. Position : Adjust the horizontal position from 0 to 100.
V. Position : Adjust the vertical position from 0 to 100.
Focus : Adjust the focus from 0 to 100.
Clock : Adjust the clock from 0 to 100.

 **Color:** Adjust the Gamma value and Color Temp.

Gamma: Allows you to adjust the luminance tone. The default value is 2.2 (standard value for Windows).

Press the  button to adjust the Gamma value.

Color Temp.: The default setting is warm. You can adjust and select Warm, Normal, Cool, or User settings by pressing the  button.

 **Performance**

Over Drive: Select Off, Normal, or Extreme.

Adaptive-Sync: To control supporting Adaptive-Sync or not. The default is On.

TR-1ms: Reduce screen dragging shadow, residual shadow. Note: It can only be enabled if refresh rate is above 75 Hz.

Refresh Rate Num: Display the panel's current refresh rate on the screen.

 **OSD**

Language: Set the OSD menu language.

OSD Timeout: Adjust the delay before turning off the OSD menu.

Transparency: Adjust the transparency of the OSD menu.

 **System**

Input: Select the source from an available input source.

Auto Source: Automatically searches for available input sources.

Wide Mode: You can select which screen aspect you are using.

DDC/CI: Allows the monitor settings to be set through the software on the PC.

Quick Start Mode: No logo is displayed on startup to improve startup speed.

 **Information**

View the basic information of the monitor. And reset all settings to factory defaults.

Supporting Timing Modes

| Mode | Resolution | Remark |
|--------|------------|--------------------|
| VGA | 640x480 | 60Hz |
| | 640x480 | 72Hz |
| | 640x480 | 75Hz |
| MAC | 640x480 | 66.66Hz |
| VESA | 720x400 | 70Hz |
| SVGA | 800x600 | 56Hz |
| | 800x600 | 60Hz |
| | 800x600 | 72Hz |
| | 800x600 | 75Hz |
| MAC | 832x624 | 74.55Hz |
| XGA | 1024x768 | 60Hz |
| | 1024x768 | 70Hz |
| | 1024x768 | 75Hz |
| MAC | 1152x870 | 75Hz |
| VESA | 1152x864 | 75Hz |
| | 1280x960 | 60Hz |
| SXGA | 1280x1024 | 60Hz |
| | 1280x1024 | 75Hz |
| VESA | 1280x720 | 60Hz |
| WXGA | 1280x800 | 60Hz |
| WXGA+ | 1440x900 | 60Hz |
| WSXGA+ | 1680x1050 | 60Hz |
| FHD | 1920x1080 | 60Hz |
| | 1920x1080 | 75Hz |
| | 1920x1080 | 100Hz HDMI Only |

Warning: Do not set the graphic card in your computer to exceed these maximum refresh rates. Doing so may result in permanent damage to your monitor.

Avertissement : Ne réglez pas la carte graphique de votre ordinateur en dépassant ces taux de rafraîchissement maximaux. Si vous le faites, cela va irrémédiablement détériorer votre moniteur.

Technical Information

Technical Specification

| | | |
|-------------------------------|--|------------------------|
| Panel | 24.5" TFT (with LED backlight) | |
| Power Management | Normal | On: 18 Watts (typical) |
| | ECO Mode 1 | On: 13 Watts (typical) |
| | Standby Mode: < 0.5 Watt | |
| | Off: < 0.3 Watt | |
| Displayable Resolution | Full HD 1920 x 1080 max. Vertical Frequency 100Hz max. | |
| Pixel Dimension | 0.283(H) x0.280(V) | |
| Display Color | 16.7M | |
| Tilt | -5°~20° | |
| Active Display Area | 543.744(H) x302.616(V) mm | |
| Temperature | Operating: 0°C ~ + 40°C Storage: -20°C ~ + 60°C | |
| Power | Input Voltage 100-240 V AC | |
| Speaker | NA | |

Wall-mount instruction

Preparing To Install The Optional Wall Mount Arm (not included)

This LED LCD Monitor can be attached to a wall mounting arm purchased separately.

Turn the power OFF then disconnect the cables from the LED LCD Monitor before performing the procedure below.

1. Lay the LED LCD Monitor face down on a soft surface.
2. Push release button and pull stand away from monitor.
3. Remove the stand base.

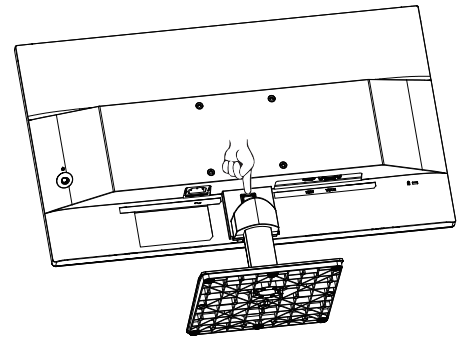

Attaching The Optional Wall Mount Arm (not supplied)

Follow these steps to finish installing the wall mounting arm:

1. Place the wall mounting arm onto the back of the LED LCD monitor. Line up the holes of the arm with the holes in the back of the monitor.
2. Insert the 4 screws into the holes and tighten.
3. Reconnect the cables. Refer to the User's Guide that came with the optional wall mounting arm for instructions on attaching it to the wall.

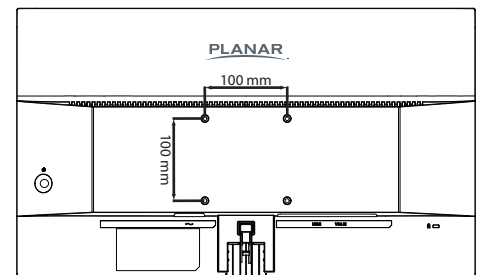

NOTE

- 100mmx100mm VESA high hole (n=4), M4, pitch =0.7 mm screw mounting kit not included.

Care and Maintenance

Care

- Avoid exposing your LED LCD monitor directly to sunlight or other heat source. Place your LED LCD monitor away from the sun to reduce glare.
- Put your LED LCD monitor in a well ventilated area.
- Do not place any heavy things on top of your LED LCD monitor.
- Make certain your LED LCD monitor is installed in a clean and moisture-free area.
- Keep your LED LCD monitor away from magnets, motors, transformers, speakers, and TV sets.

Note

- Move the LED out of the package and take off the plastic bag and Polystyrene Foam.
- Pull the base from Parallel versus Panel to Vertical.
- Adjust the Panel within -5 degree leaning forward and 20 degree leaning backward.

Safety Tips

- If smoke, abnormal noise or odor came out from your LED LCD monitor, caution you should remove the power cord immediately and call your service center.
- Si de la fumée, un bruit anormal ou une odeur s'échappait de votre moniteur, débranchez immédiatement le cordon d'alimentation et appelez votre centre de service.
- Never remove the rear cover of your LED LCD monitor cabinet. The display unit inside contains high-voltage parts and may cause electric shock to human bodies.
- Never try to repair your LED LCD monitor yourself. Always call your service center or a qualified technician to fix it.

Troubleshooting

No power

- Make sure A/C power cord is securely connected to the power adapter and the power supply is firmly connected to the LED LCD monitor.
- Plug another electrical device into the power outlet to verify that the outlet is supplying proper voltage.
- Make sure all signal cables are installed.

Power on but no screen image

- Make sure the video cable supplied with the LED LCD monitor is tightly secured to the video output port on back of the computer. If not, tightly secure it.
- Adjust brightness.

Wrong or abnormal colors

- If any colors (red, green, blue) are missing, check the video cable to make sure it is securely connected. Loose or broken pins in the cable connector could cause an improper connection.
- Connect the LED LCD monitor to another computer.

Planar Support

Cables and Accessories

To find cables and accessories for your Planar monitor, touch screen or other Planar products visit our online store at www.PlanarOnline.com.

Technical Support

Visit Planar at <http://www.planar.com/support> for operations manuals, touchscreen drivers, warranty information and access to Planar's Technical Library for online trouble shooting.

To speak with Planar Customer Support please have your model and serial number available and dial:

Planar Support

Tel: 1-866-PLANAR1 (866-752-6271) or +1 503-748-5799 outside the US.

Hours: 24 hours a day, 7 days a week.

Toll or long distance charges may apply.

European Product Database for Energy Labeling (EPREL)

PLN2501 Registration number: 1983406

Planar Systems, Inc.

Customer Service

24x7 Online Technical Support: <http://www.planar.com/support>

1195 NE Compton Drive

Hillsboro, OR 97006

Tel: 1-866-PLANAR1(866-752-6271), or +1 503-748-5799 outside the United States,

Hours: 24 hours a day, 7 days a week

© 04/2024 Planar Systems, Inc.

Planar is a registered trademark of Planar Systems, Inc. Other brands and names are the property of their respective owners. Technical information in this document is subject to change without notice.