

# LEYARD MG-2COB SERIES

## COB INDOOR FINE PITCH LED DISPLAY



- Available in 0.93, 1.25, 1.56mm pixel pitch
- Front/rear installation and front access
- 16:9 cabinet in 600x337.5x39.9mm, cabinet is 4.3KG only
- Micro LED full flip-chip, high EO efficiency, reliability
- COB module, IP65
- Real pixel available
- Modules without bracket, attached to cabinet frame directly
- Selectable control system: Nova/CLT



## HISTORY MG FAMILY



### MG-2COB

#### Upgrade

|                        |   |
|------------------------|---|
| Thinner                | From 53mm to 39.9mm, 13.1mm less                    |
| Lighter                | From 6KG to 4.3KG, 1.8KG less                       |
| All in MicroLED        | Flipchip, 3x6mil, <80µm                             |
| Better Protection      | IP65 front COB module                               |
| Surface Light Emission | Higher fill factor, no pixelization compared to SMD |
| Smarter                | Optional diagnostic feature                         |
| Cableless              | All cables are inside of the cabinets               |



### LED - COB

- COB emit the light like a surface light device. There is no moiré effect or pixelization
- COB module is rugged with better LED production
- COB has a much better protection on both dust and water. You can clean it with a wet cloth

|            |                                      |                                |                      |
|------------|--------------------------------------|--------------------------------|----------------------|
| <p>SMD</p> | <p>SMD soldering force = 1kg</p>     | <p>SMD hit test</p>            | <p>Hardness test</p> |
| <p>COB</p> | <p>COB soldering force &gt; 10kg</p> | <p>COB hit test &gt; 10 KG</p> | <p>Easy to clean</p> |

## Scientific and Reasonable Layout, Highlighting the Aesthetics of Technology

- > Dual signal redundancy plus loop redundancy; Dual power redundancy;
- > AC input at bottom and output at top, plus 300mm distance between power and data interfaces to reduce the interference to signal;
- > Float connectors between hub and modules for stable connection.

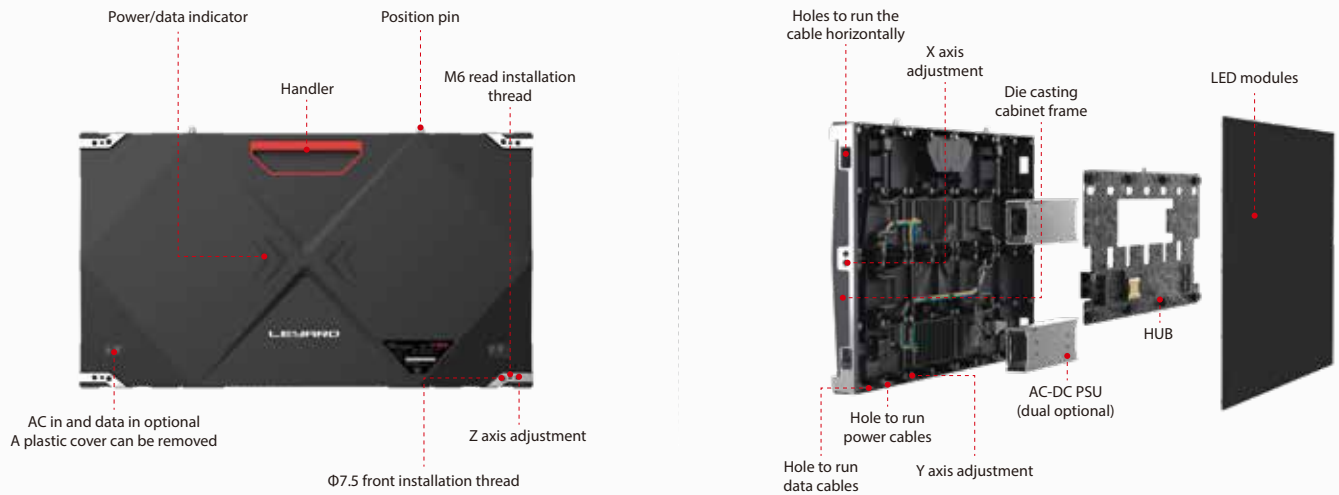

## Full Flip Chip

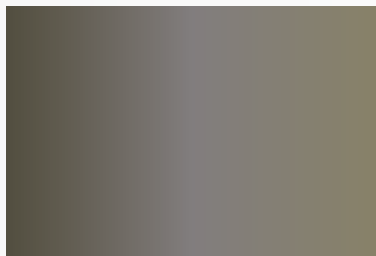

Wired LEDs, the gold/copper wire cosmetics the LED wall color



Flip chip LEDs are super black

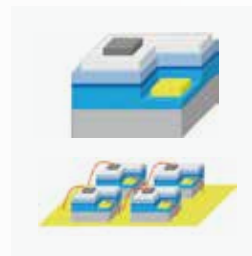

Wired LED

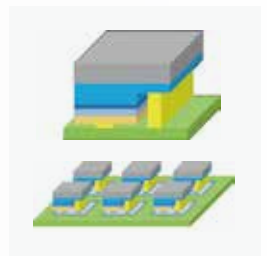

Flip chip

## Front Access, Fast Installation

Multiple installation method, front/rear installation and front access.



## Flat, From Modules to Displays

Experience of fine pixel pitch in decades, the superior performance.

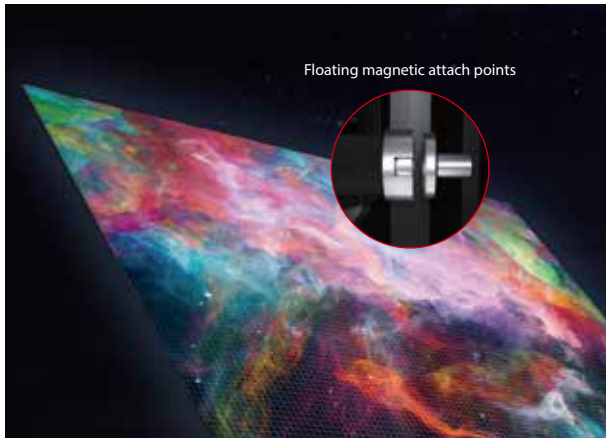

## High Contrast

Adopting LeadDark tech, the contrast ratio can reach to 25000:1.



## More Details at Low Brightness

The display is 16 bits to deliver high greyscales at low brightness area.

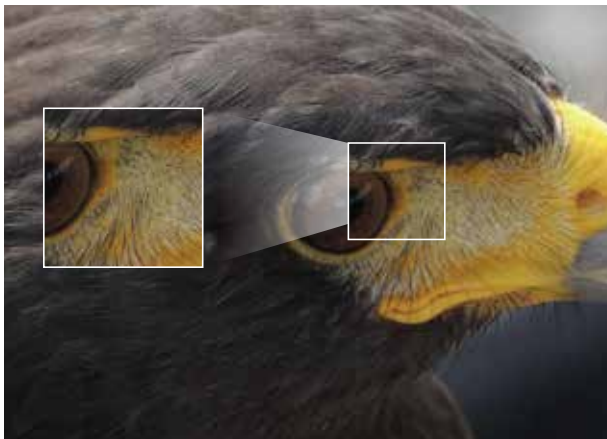

## HDR - High Dynamic Range

HDR content is in 10 bits, new gen MG can deliver a much bigger color volume than SDR LED display



## Floating Connectors

The time-proved connection method, introduced by Leyard into the LED display industry.

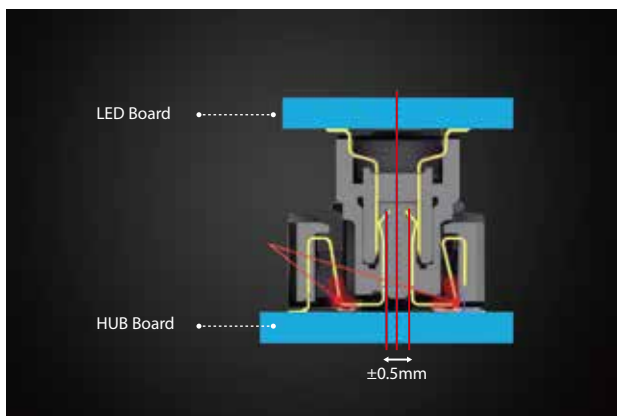

## Diagnostic (optional)



Power Status



Temperature Alert



Humidity Alert



Smoke Detection



Abnormal Status



## EXTENSIVE APPLICATIONS

Leyard MG-2COB Series indoor fine pitch LED displays are engineered for exceptional visual performance and reliability, ideal for environments demanding high-resolution and uninterrupted viewing. Its COB technology enhances durability, protecting against dust, moisture, and impact, while ensuring a seamless, bezel-free viewing experience. With their advanced design, the Leyard MG-2COB series supports both front and rear installation, providing flexibility in various architectural settings and making them a top choice for premium indoor applications.



## FOR WORLDWIDE MARKET

Leyard MG-2COB Series has passed the international and domestic authority of electrical, safety, electromagnetic radiation, environmental protection certificates, including CCC, HDR, CE, CB, cTUVus, FCC, ROHS, REACH, WEEE, etc.



## SPECIFICATIONS



| Item                                      | MG0093-2COB        | MG0125-2COB            | MG0156-2COB        |
|---|--------------------|------------------------|--------------------|
| Pixel Configuration                       | Full Flip Chip COB | Full Flip Chip COB     | Full Flip Chip COB |
| Pixel Pitch (mm)                          | 0.93               | 1.25                   | 1.56               |
| Module Resolution (dots)                  | 160x180            | 120x135                | 192x108            |
| Module Size (mm)                          | 150x168.75x9       | 150x168.75x9           | 300x168.75         |
| Unit Area (m <sup>2</sup> )               | 0.2025             | 0.2025                 | 0.2025             |
| Module Composition (WxH)                  | 4x2                | 4x2                    | 2x2                |
| Cabinet Resolution (dots)                 | 640x360            | 480x270                | 384x216            |
| Pixel Density (Point/m <sup>2</sup> )     | 1,137,778          | 640,000                | 409,600            |
| Cabinet Dimension (WxHxD)mm               |                    | 600x337.5x39.9         |                    |
| Weight per Cabinet (Kg)                   |                    | 4.3                    |                    |
| Weight per Sqm (Kg)                       |                    | 21.5                   |                    |
| Brightness Max Calibrated (nit)           | 700-800*           | 500-600*               | 500-600*           |
| Colour Temperature, Adjustable (K)        |                    | 3000~10000 Adjustable  |                    |
| Viewing Angle (Horizontal) <sup>o</sup>   |                    | 170                    |                    |
| Viewing Angle (Vertical) <sup>o</sup>     |                    | 150                    |                    |
| Contrast Ratio                            | 25000:1            | 25000:1                | 25000:1            |
| AC Operation Voltage                      |                    | AC100~240V             |                    |
| Max Power Consumption (W/m <sup>2</sup> ) | 505                | 420                    | 395                |
| Ave Power Consumption (W/m <sup>2</sup> ) | 175                | 125                    | 114                |
| Grayscale (Bits)                          | 16                 | 16                     | 16                 |
| Refresh Rate (Hz)                         | 1600-3840          | 1600-3840              | 1600-3840          |
| Frame Rate (Hz)                           | 50&60              | 50&60                  | 50&60              |
| Lifetime (hrs)                            |                    | 100,000                |                    |
| Installation Access                       |                    | Rear/Front             |                    |
| Module Maintenance                        |                    | Front                  |                    |
| PSU & Others Maintenance                  |                    | Front                  |                    |
| Operating Temperature (°C)                |                    | -10~40                 |                    |
| Storage Temperature (°C)                  |                    | -20~60                 |                    |
| Operating Humidity (%RH)                  |                    | 10~80% no condensation |                    |
| Storage Humidity (%RH)                    |                    | 10~85% no condensation |                    |

\*The power consumption tolerance is ±10%.

- All the above parameters are for reference, the details are subject to the actual situation.

Note: The product parameters, descriptions and images are subject to change without prior notice.